

Date: 2023-11-23  
 Enquiry dated:  
 Project:  
 Quotation-no.:  
 Item:  
 Reference:



**Evaporator (dx) GHF 040.2H/27-ENW50.E For calculation only!**

Capacity:	10.5 kW <sup>(1)</sup>	Refrigerant:	R134a <sup>(2)</sup>
Surface reserve:	0.0 %	Evaporation temp.:	-8.0 °C
Air flow:	6060 m <sup>3</sup> /h	Superheating:	5.0 K
Air inlet:	0.0 °C	Condensing temp.:	35.0 °C
Air outlet:	-4.1 °C	Subcooled temp.:	30.0 °C
Air pressure:	1013 mbar		

Fans:	2 Piece(s) 1~230V 50Hz	Noise pressure level:	55 dB(A) in 3.0 m <sup>(3)</sup>
Data per motor (nominal data):		Noise power level:	77 dB(A)
Speed:	1390 min-1	Air throw:	approx. 30 m <sup>(4)</sup>
Capacity (mech./el.):	0.22 kW/0.23 kW	Frost:	0.0 mm
Current:	1.05 A <sup>(5)</sup>		
ErP:	Compliant <sup>(6)</sup>		

Total el. power consumption:	0.43 kW	Energy efficiency class:	C (2014)
------------------------------	---------	--------------------------	----------

Casing:	AlMg, Powder coated RAL 9003	Tubes:	Copper <sup>(7)</sup>
Surface:	39.2 m <sup>2</sup>	Fins:	Aluminum <sup>(7)</sup>
Tube volume:	13.9 l	Distr. press. drop:	0.8 bar
Fin spacing:	7.00 mm	Outlet connection:	35.0 * 1.50 mm
Dry weight:	75 kg <sup>(8)</sup>	Inlet connection:	22.0 mm
Max. operating pressure:	32.0 bar	PED classification:	Category I, module A <sup>(9)</sup>

- Dimensions:**
- L = 1770 mm
  - B = 580 mm
  - H = 550 mm
  - E = 680 mm
  - F = 425 mm
  - C = 210 mm
  - A = 400 mm
  - ØD = 11 mm
  - K = G1¼

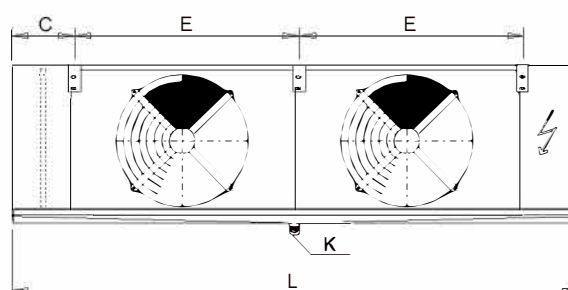
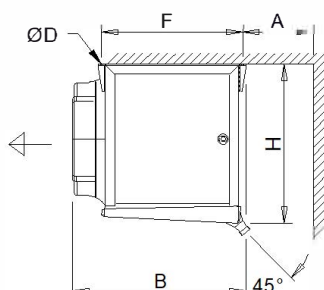

Drain according to DIN ISO 228-1 with G-thread (flat gasket).  
 Attention: Drawing and dimensions not valid for all accessory options!